

AVAILABLE

2,294 SF Office Downtown
Greensboro, North Carolina



125 South Elm Street Greensboro, NC

- Available 2/1/07
- 2,294 Square Feet
- Top floor Suite 601
- Overlooks Elm Street
- Full Service Lease
- Ample On-site Parking
- Lease Price: \$17.00 PSF



125 South Elm Street, Suite 303
Greensboro, North Carolina 27401
Phone: 336-282-3773 Fax: 336-288-2120
www.simpsonandschulman.com

All information provided regarding property for sale, lease, or financing is from sources deemed reliable, but no warranty or representation is made as to the accuracy thereof and same is submitted subject to errors, omissions, change of price, lease or other conditions, prior sale, lease or financing or withdrawal without notice. No liability of any kind is to be imposed on the broker herein.

FLOOR PLAN

125 South Elm Street
Greensboro, NC

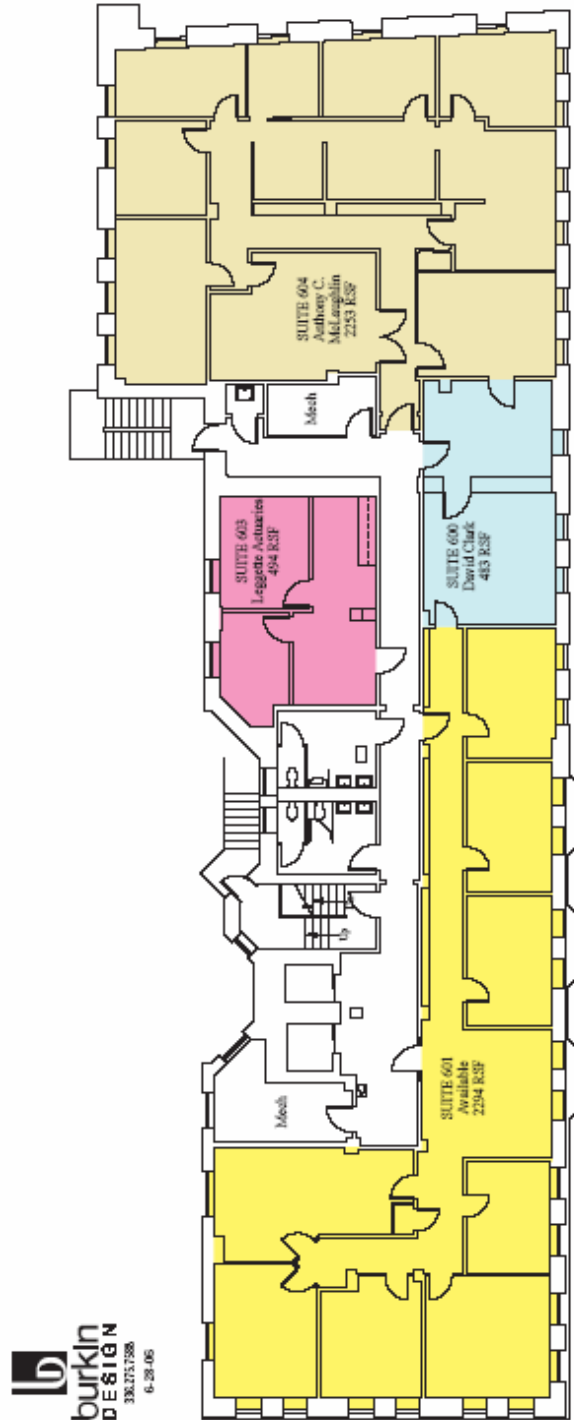

All information provided regarding property for sale, lease, or financing is from sources deemed reliable, but no warranty or representation is made as to the accuracy thereof and same is submitted subject to errors, omissions, change of price, lease or other conditions, prior sale, lease or financing or withdrawal without notice. No liability of any kind is to be imposed on the broker herein.