

AVAILABLE

1409 and 1411 Mill St



1409 and 1411 Mill St
Greensboro, NC 27408

39,825 on 2.08+/- acres
Zoned LI
Great property for
redevelopment
Battleground and Wendover
Ave exposure



LEASE PRICE

\$5.50 NNN

SALE PRICE

\$3,000,000

COMMERCIAL REAL ESTATE

**SIMPSON
SCHULMAN
& BEARD**
COMMERCIAL REAL ESTATE

FOR MORE INFORMATION

336.282.3773

125 South Elm Street Suite 103, Greensboro, NC 27401

www.simpsonandschulman.com

AVAILABLE

1409 and 1411 Mill St

39,825 SF

Building Size	39,825 SF
Site Acreage	2.08 ACRE
Expansion Capability	N/A
Column Spacing	20' X 25'
Ceiling Heights	16 X 18'
Floor Specifications	6"
Loading Docks	3
Zoning	LI
Parking	AMPLE
Water/Sewer	CITY OF GREENSBORO
Natural Gas	PIEDMONT NATURAL
Electricity	DUKE POWER
Lease Rate	\$5.50 NNN
Sale Price	\$3,000,000

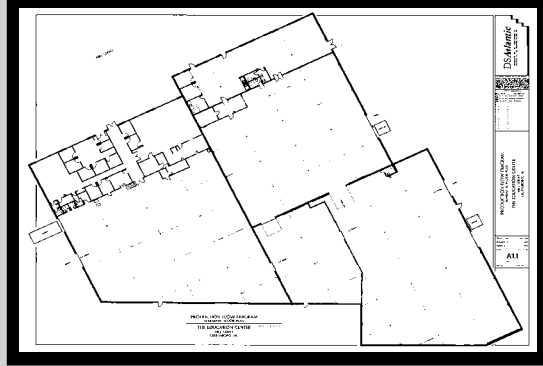

COMMERCIAL REAL ESTATE

336.282.3773 • 125 South Elm Street Suite 103, Greensboro, NC 27401 • www.simpsonandschulman.com

All information provided regarding property for sale, lease, or financing is from sources deemed reliable, but no warranty or representation is made as to the accuracy thereof and same is submitted subject to errors, omissions, change of price, lease or other conditions, prior sale, lease or financing or withdrawal without notice. No liability of any kind is to be imposed on the broker herein.